

EXPLORER STARSHIP DECK PLANS.

EVERYTHING IS LUXURIOUS AND AS STATE OF THE ART AS THE 1990s.

The new *Explorer Starship* is designed to enchant you with an ambience of luxurious, casual elegance. Public rooms with furnishings and color schemes designed to appeal to the most sophisticated tastes—yet so cozy they encourage warm and friendly gatherings. Staterooms more spacious than you'd ever expect to find on a cruise ship. Each one an outside room, with either large view windows or portholes at scenery level—and a wealth of conveniences and surprises, including large double closets, luxury bathrooms, well-stocked refrigerator-bars. Everything to make you feel at home in the lap of luxury.

EXPLORER STARSHIP AT A GLANCE.

Length, 407.5 feet. Beam, 52.5 feet. Draft, 15.8 feet. 7 decks. Up to 16 knots cruising speed. Built 1986. Bahamian registry. Fully stabilized. Air conditioned throughout. 248 lower berths. 17 upper berths. 250 passengers, total capacity. 124 staterooms. Bow thrusters for excellent maneuverability.

ALL OUTSIDE STATEROOMS WITH STATE-OF-THE-ART INNOVATIONS.

Every stateroom has six channel, color TV; video movie cassette playback unit (with a full range of films available free of charge at the on-board Video Library). You'll have radio and music selection channels. Plus all these other modern-living conveniences: deluxe bathroom with built-in hair dryer; individual cabin control of heat and/or air conditioning; telephone for world-wide calls as well as on-board communication; automated, computerized wake-up call service; a stocked refrigerator mini-bar. And the highest vessel standards for air quality and sound insulation.

FAMILY ROOMS. Staterooms 306 and 332 provide two additional upper berths to accommodate four in the room.

TRIPLES. Staterooms 310, 315, 316, 317, 319, 330, 335, 337, 339, 405, 408, 434 and 435 offer an additional upper berth to accommodate three in a room.

THE MOST ELEGANT BATHROOMS AT SEA come complete with deluxe appointments, such as built-in hairdryers and gleaming tile. All staterooms have showers, and suites have both shower and tub. Large size mirrors make shaving and putting on makeup more comfortable and relaxed.

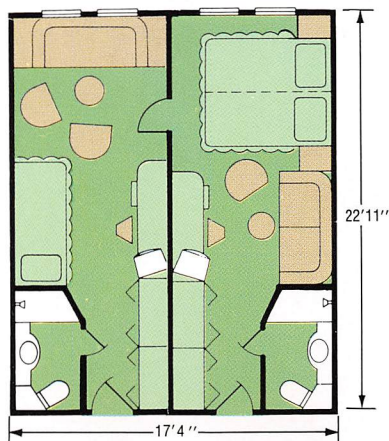

◀ **PARLOR SUITES.** A number of Staterooms on Deck 4 feature connecting doors and may be combined to offer the largest suites afloat. Large, spacious accommodations, the Parlor Suites provide extraordinarily deluxe amenities for the *Explorer Starship* guest.



▶ **VERANDA SUITES.** World class accommodations at sea. Sliding glass doors leading onto spacious private verandas. Living room elegance. Bedroom comfort with beds configured as queen-size or two separate twins. Well-stocked refrigerator. Luxury tile bathroom with both tub and shower, and built-in hair dryer. Telephone for world-wide and shipboard calls. Color television, video cassette player and the most modern security system.

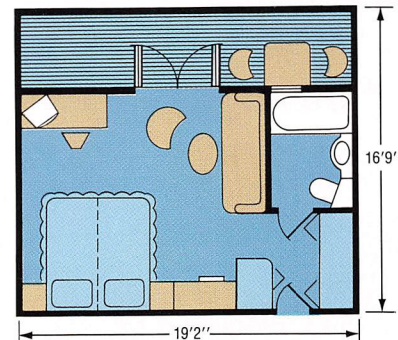

DECK 8

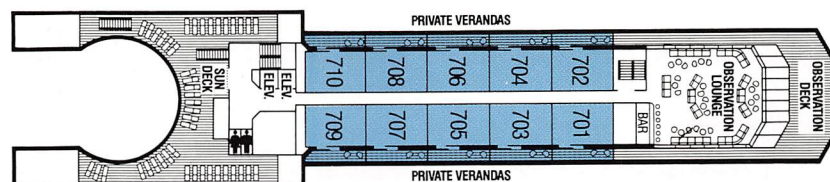

DECK 7—VERANDA SUITES

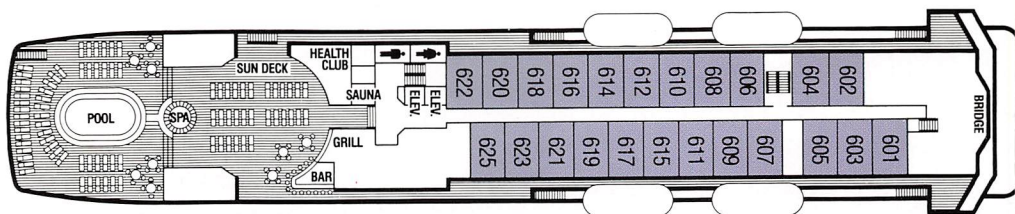

DECK 6—DELUXE STATEROOMS

EXPLORER CLASS CARIBBEAN FLEET

**SMALL SHIPS THAT
CRUISE WHERE
THE BIG SHIPS CAN'T!**

**YOUR CHOICE OF SIZE—
CRUISING WITH 250, 158 OR LESS
THAN 100 FELLOW ADVENTURERS!**

**YOUR CHOICE OF STYLE—
ULTRA DELUXE, CASUAL ELEGANCE
OR INTIMACY AND CHARM.**



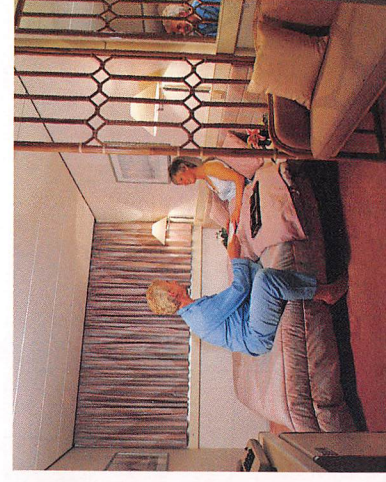
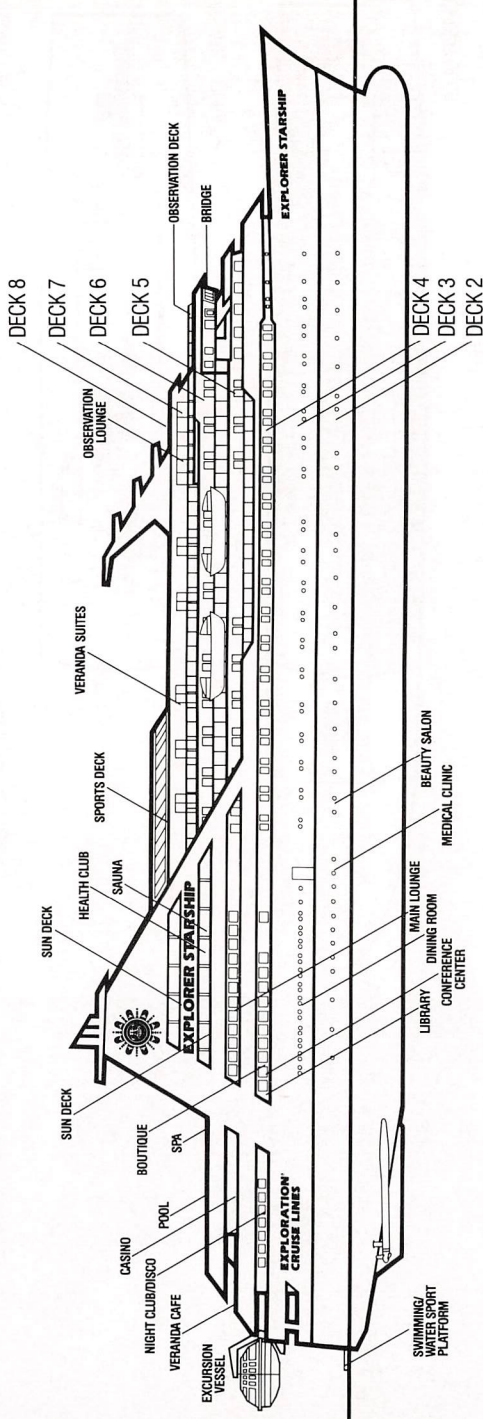
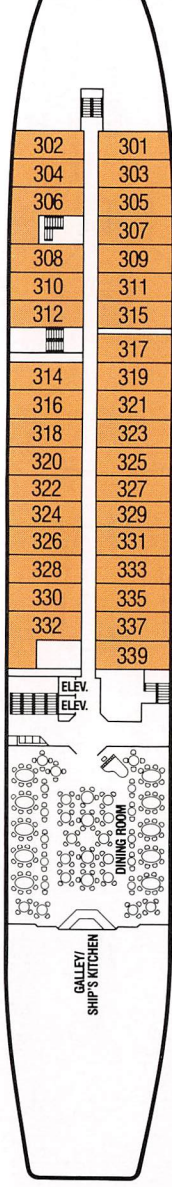
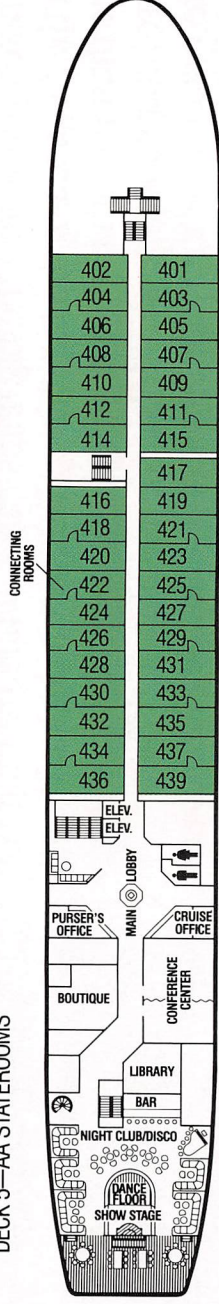
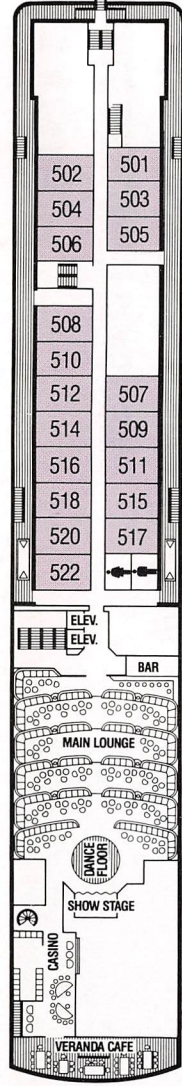

DELUXE/AA STATEROOMS. Everything to make you feel like a welcomed, pampered guest. Deluxe Staterooms on Deck 6; AA Staterooms on Deck 5. Large view windows. The height of spaciousness and taste. Twin sofas in the latest, state-of-the-art design, or may be configured as a queen-sized bed. Roomy double closets. Color television. Video cassette player. Well-stocked refrigerator. Luxury tile bathroom with built-in hair dryer. Telephone. Individually controlled air conditioning. Modern security system.

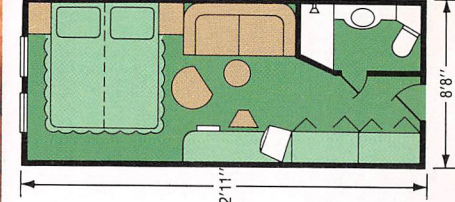
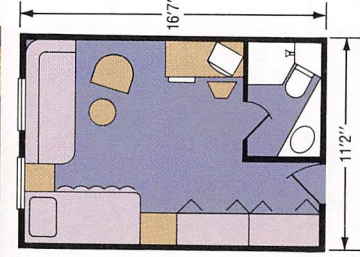

A OR B STATEROOMS. A Staterooms are located on Deck 4; B Staterooms on Deck 3. Large view windows on the higher deck, port-holes on Deck 3. Both categories offer two room configurations. Superbly furnished with either the latest design sofa by day and twin bed by night, an additional twin bed, two chairs, desk and table; or an alternative choice is a luxurious

bed arrangement that may be configured as queen size or two separate twins, with sofa and chair, desk and table. Refrigerator and all other elegant accoutrements, including roomy double closets, luxury tile bathroom, telephone, TV, video cassette player, and modern security system.

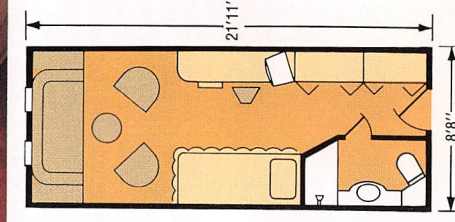

NORTH STAR

THE MOST VERSATILE EXPLORER CLASS SHIP.

In the true Explorer Class tradition, the smaller *North Star* takes you where the big ships can't, while treating you to all the luxuries of the big ships. With seven decks, there's a view dining room and lounge, swimming pool, sun deck, theatre, trapshooting, shuffleboard, and library. When you're ready to retire, your spacious, beautifully furnished outside stateroom awaits.

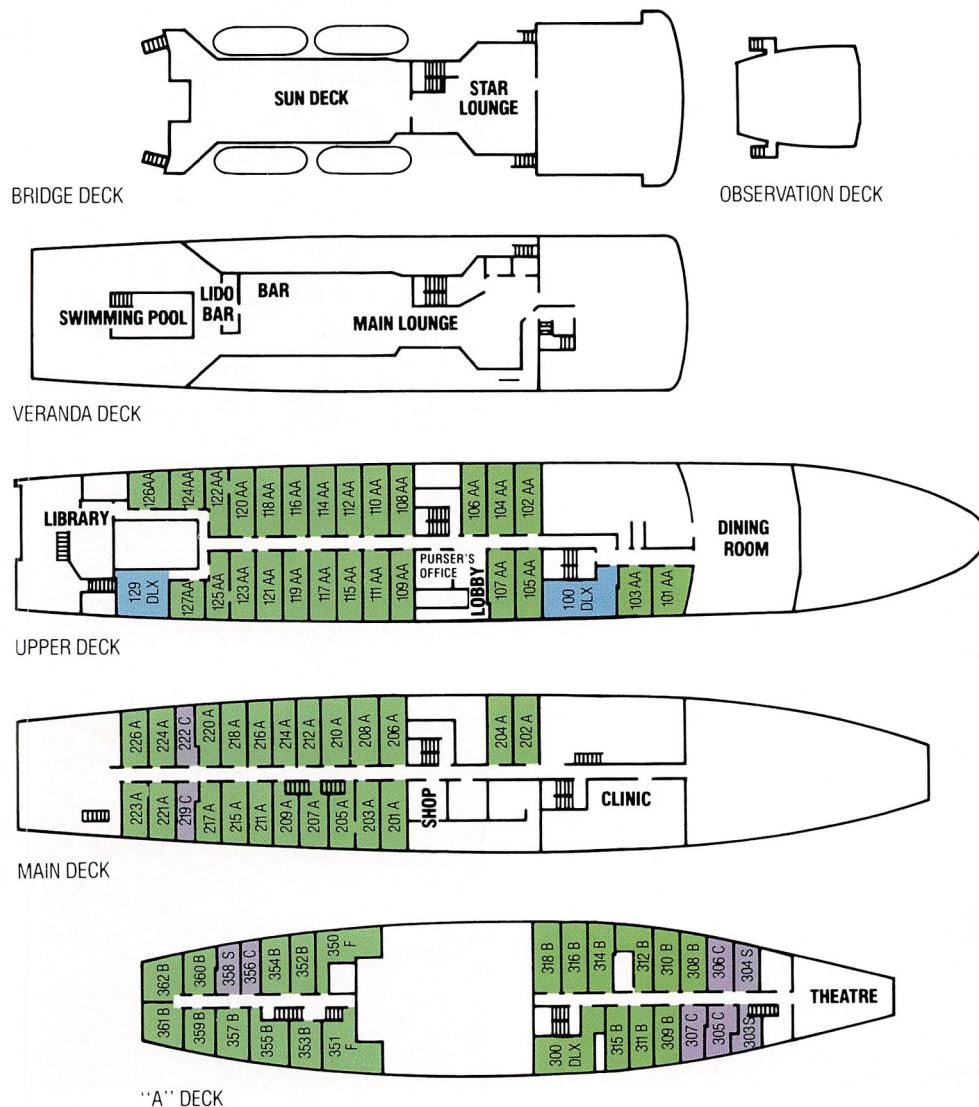

NORTH STAR AT A GLANCE. Length, 295 feet. Width, 46 feet. Tonnage 3,095 grt. Cruising speed up to 13.5 knots. 80 outside state-rooms. Bahamian registry with U.S. Coast Guard Cer-tification. 158 passengers. Fully stabilized.



STATEROOMS. All are out-side staterooms and fully equipped with complete private facilities. Also, indi-vidually controlled temper-ature and air conditioning. They are spacious, beau-tifully furnished, and the majority are larger than those of most cruise ships.

FESTIVE PARTIES AMIDST TROPICAL BEAUTY. Aboard the *North Star*, you'll enjoy parties with exquisite cui-sine, colorful decorations

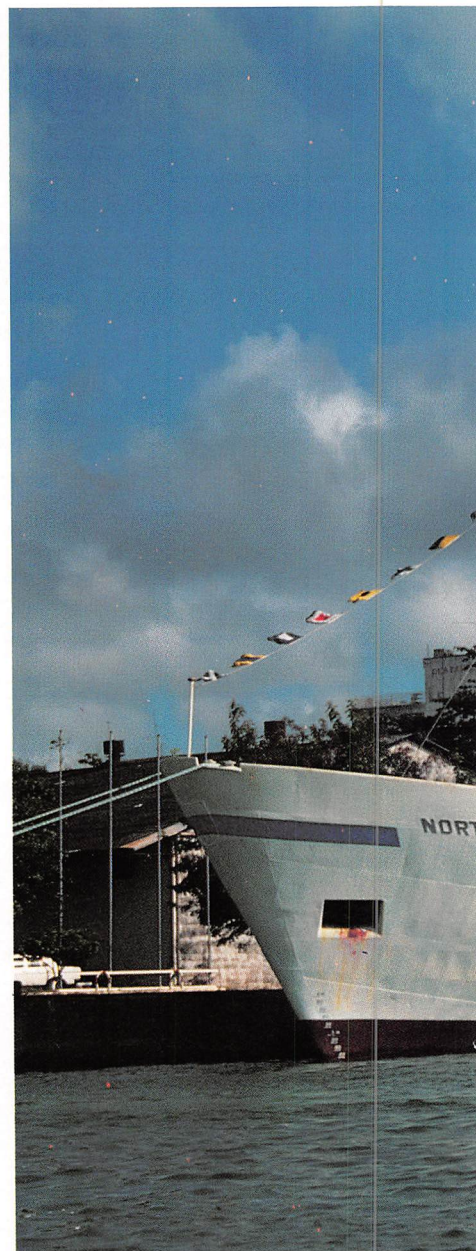

DELUXE ROOMS. These are the largest and finest accommodations aboard, offering a separate sitting room. Rooms feature double or twin beds. The sofa in the sitting room can be converted to an extra bed. Large view windows. Tele-vision and refrigerator.

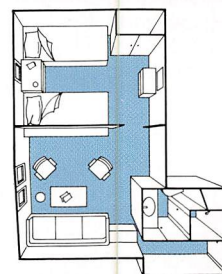

and refreshing cocktails. Surrounded by all the lovely tropical scenery, these good times seem even better.